

Acousti-Mat 3 Wall Isolation Detail

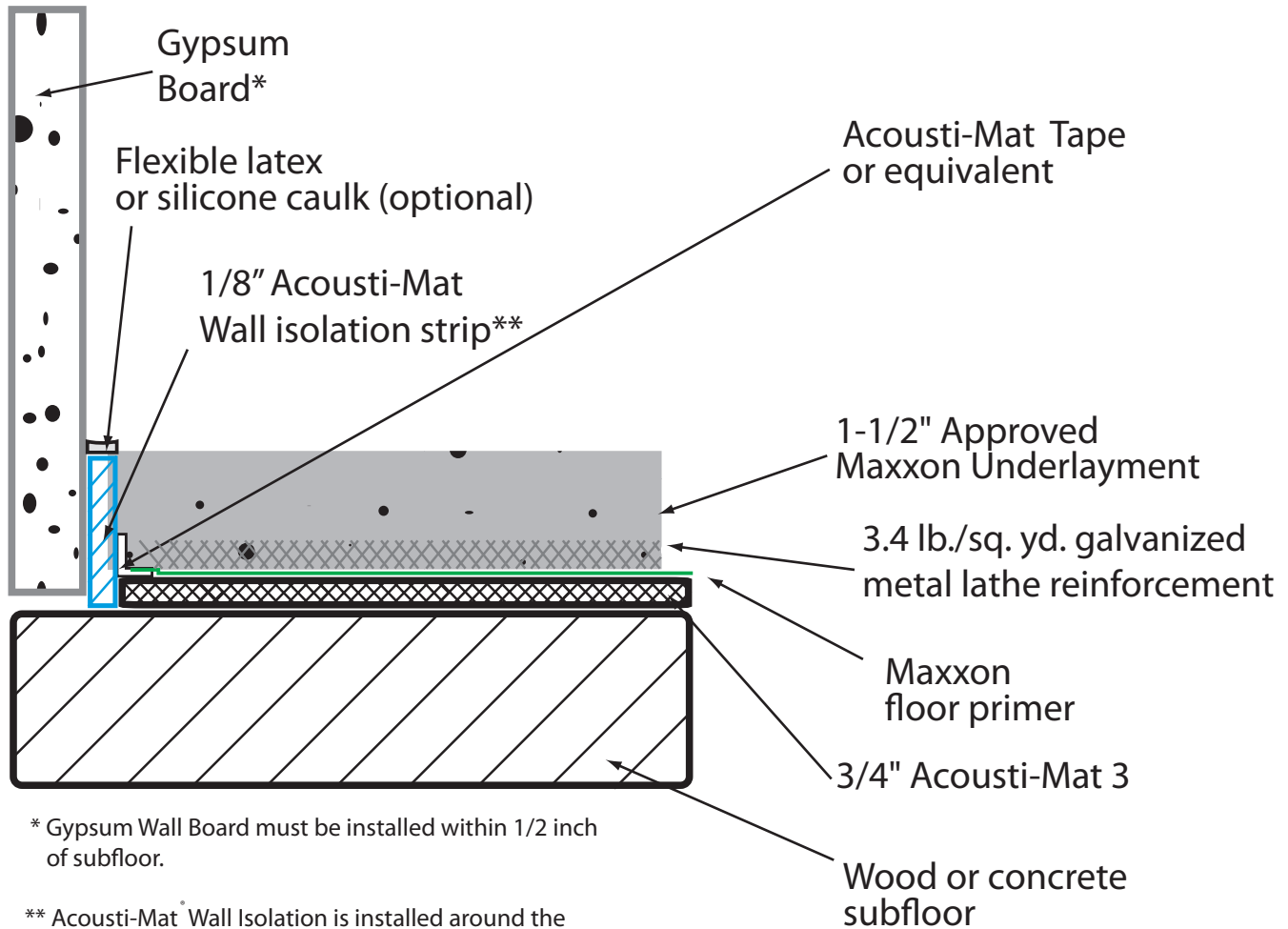

* Gypsum Wall Board must be installed within 1/2 inch of subfloor.

** Acousti-Mat Wall Isolation is installed around the perimeter of the entire room to receive Acousti-Mat II, and around any floor penetrations such as toilet collars, electrical, plumbing, etc.

2D-AM3-MXU-001